

Established 1763
St. JOSEPH CHURCH

4590 St. Joseph Way, Pomfret, MD 20675
301-539-3903 • Fax 301-539-3912 • Website: stjoeopomfret.weconnect.com

LIST OF ABBREVIATIONS

Table with columns of abbreviations and full names, including terms like ALIGN BOLT, ANCHOR, ABOVE, AUTOMATIC CLOSING, etc.

GENERAL NOTES

- 1. All work shall be done in strict accordance with applicable codes, ordinances, regulations and any additional requirements...
- 2. All construction shall be completed in compliance with the Occupational Safety and Health Act...

- 11. Where a model number of an item has been referenced, it is not the intention of the Architect/Engineer to ask of him to standard or improved model...
- 12. All openings shall be structurally supported by loose steel or precast inlets, beams or ring plates...

- 20. No modifications, relocations, etc. shall be made which inhibit or interfere with the intended use of the space nor shall any installations be exposed which are intended to be concealed without prior approval in writing...
- 21. The Contractor shall notify the Owner and/or Architect of any major deviations or differences in conditions of the work that would materially affect the quality of the work and/or completion of the contract.

LEGEND OF SYMBOLS

Table of symbols for elevations, windows, spaces, sections, details, notes, doors, earth types, insulation, lumber, and scale details.

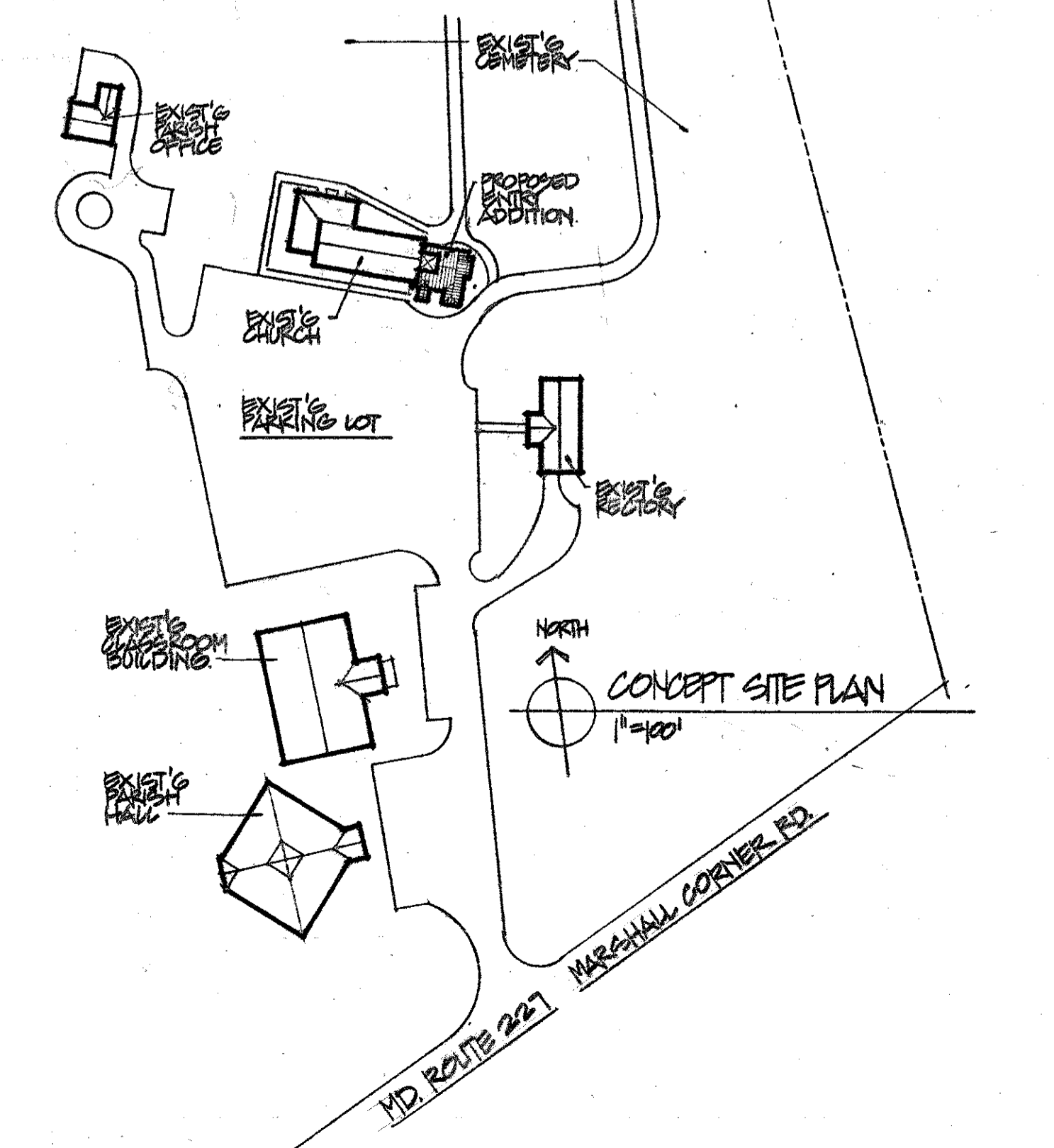

LIST OF DRAWINGS

- A-1 COVER SHEET, GENERAL NOTES, ABBREVIATIONS, SYMBOLS, CONCEPT SITE PLAN, INDEX
- A-2 BUILDING DATA & CODE ANALYSIS, WITH SCALE FLOOR PLANS, EXTERIOR ELEVATIONS SCHEDULE
- A-3 FOUNDATION PLAN (1/4 SCALE), FLOOR PLAN (1/4 SCALE), WINDOW LOCATION PLAN, STRUCTURAL NOTES

I HEREBY CERTIFY THAT THESE PLANS WERE PREPARED BY ME OR UNDER MY DIRECT SUPERVISION AND THAT I AM A DULY LICENSED ARCHITECT UNDER THE LAWS OF THE STATE OF MARYLAND.

PROJECT TITLE

ST. JOSEPH'S CHURCH ENTRY VESTIBULE
ADDITION AND MODIFICATIONS
4590 St. Joseph's Way
Pomfret MD 20675

Thomas K. Reinecker AIA
Architect

12002 Palisades Dr. 301-855-9030
Dunkirk, MD 20754 Fax 410-257-0777

Table with columns for date and sheet number.

SHEET TITLE
COVER SHEET, GENERAL NOTES, ABBREVIATIONS, SYMBOLS, CONCEPT SITE PLAN, INDEX

DATE: 12-20-15 SHEET NUMBER:

A1