

Dear St. Katharine Drexel School Parents/Guardians,

We are well on our way with the renovation of the church, and the connection of it to the school! Exciting things are yet to come!

We now have partially laid the parking lot area behind the school. We have attached a map of the updated drop off/pick up directions to use until the next phase.

The staff of SKD would like to inform you of the temporary needed change to the dropping off and picking up of your students during the renovation of the church.

For Preschool through Grade 3 families:

The school side of James Street will be a **drop off only** zone. You may pull over, have your child(ren) exit the vehicle, and then leave. Do Not park across from school on James St. and allow your child to cross. Or you may pull into the parking area on the east side of the school, coming in from James Street, parking in a stall, bringing in your child, and then exiting onto James Street. Please be courteous and accommodating, allowing extra time. You may also use the Parish Center parking lot across the street.

For all other families:

We ask that you use the Parish Center parking lot as a drop off location for your children. The crossing guard will safely usher the children across the street. The guard is generally there from 7:40am-8:10am and again from 3:00pm-3:25pm. We ask that you enter the Parish Center parking lot from S. Spring Street and exit onto Mill Street. Please be sure to talk to your children about the importance of crossing in the designated crossing zones in the streets. Impress upon them the need to practice safety and caution first and at all times.

For any long term parking during school hours, you will need to use the Parish Center parking lot or the north side of S. Spring St. Please do not drop your children off on the north side of S. Spring St. unless you have them walk to the crossing guard. The only legal and safe locations for them to cross are in the painted crosswalk areas.

Please be reminded that we are in a school zone of 15mph when children are present. We will be asking for reminders from the city to be given to the general public to abide by that law. We also ask that you drive with utmost care through any of the parking areas.

We would like to thank you for your attention to the safety of our children, staff, and workers. This is the responsibility of everyone, individually and collectively. By working together responsibly and courteously, we will keep all involved as safe as possible. Please share this information with all who assist you with the pick up and drop off of your children.

We are continued to be blessed by the strength of our faith. We ask for your continued support and prayers for the renovation of our church. It is the focal point of our faith, and it is our desire to not only take care of God's house, but His children as well.

If you have any questions, comments, or concerns, I would like to speak with or meet with you. I can be reached at the Parish Center at the number listed below.

Your fellow servant in Christ,

Barbara Heinzen
Director of Administration and Stewardship
920-887-2082, ext. 301
heinzenb@stkatharinedrexelbd.org

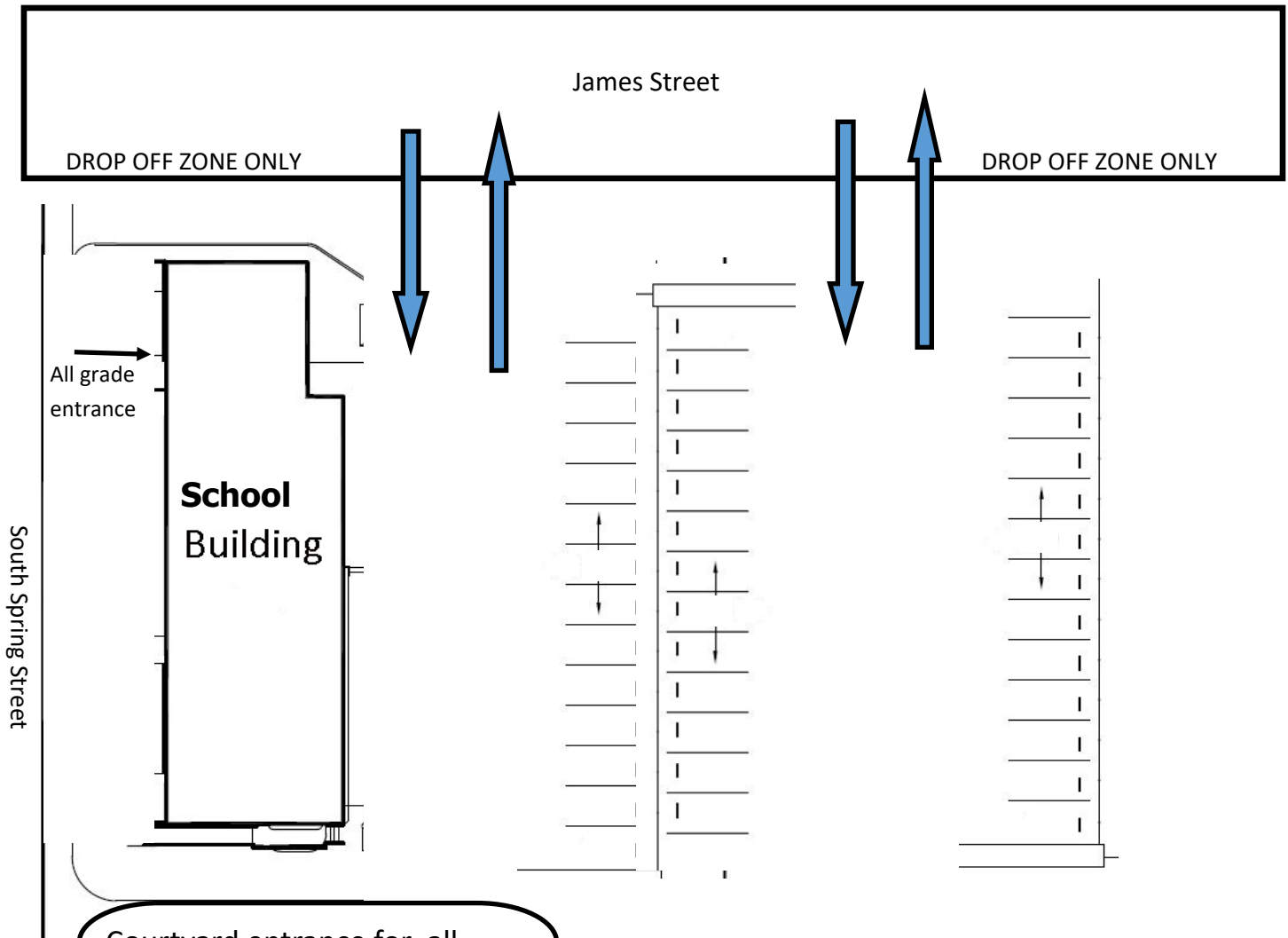

Courtyard entrance for all grades in the morning.
Pick up only for Preschool through 3rd grade .

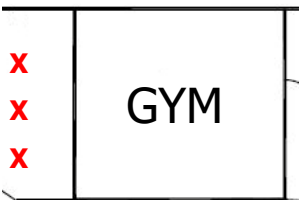

NO entrance through the gym lobby is allowed.

Please remember that South Spring Street is NOT a drop off location.

No parking on the school side of James St. is allowed; it is a drop off only zone.

The Parish Center parking will be used for drop off of 4th—8th grade students—a crossing guard is on duty before and after school for safely crossing the busy street (all grades can use the Parish Center parking lot as an option if you choose).

The courtyard entrance can be used for drop off of all grades, however, it is used for pick up of ONLY Preschool-3rd grade.

Do NOT use the gym lobby as an entrance/exit.

We will use this process until further notice.

Thank you for your patience and understanding!