

DROP OFF PROCEDURES

Beginning at 7:15AM, Morning Care will be offered in the school Cafeteria until 7:45AM. All students will need to report directly to the cafeteria. After 7:45AM students will report directly to their classrooms. PreK and K will report directly to the Library.

Cones will be placed in the center lane of the front loop beginning at 7:15AM. Please be attentive to any students who are riding their bikes.

Please do not park your car anywhere in front of the main entrance or in the loop during morning drop off. If you need to assist your child(ren) into the building then please park in the parking lots behind the Multipurpose Facility or next to the Family Center. Cars stopping in the loop slows down traffic.

Please do not pull out of line and pass cars on the left hand side. This is to ensure the safety of the students who are exiting from the left side of their cars. We recommend that all students exit from the right if possible.

Please do not drop your students off at the side of the school and continue straight by passing the loop. We would like you to drop your child(ren) off in the loop closest to one of the Drop Off volunteers or Faculty Member.

Please drive slow and be patient. If you are feeling pressed for time or running late we would rather have everyone be safe than have an accident.

Please do not talk on your cell phone during Drop Off. We all are very aware of the distraction this causes and the increased potential for an accident.

Please do not park in the Fire Lanes at any time during or after school. We cannot prevent a ticket being given even if it is just for a few minutes.

The tardy bell for all students is 8:00 AM. Parents must walk students who are tardy into the main office and sign them in.

Drop Off

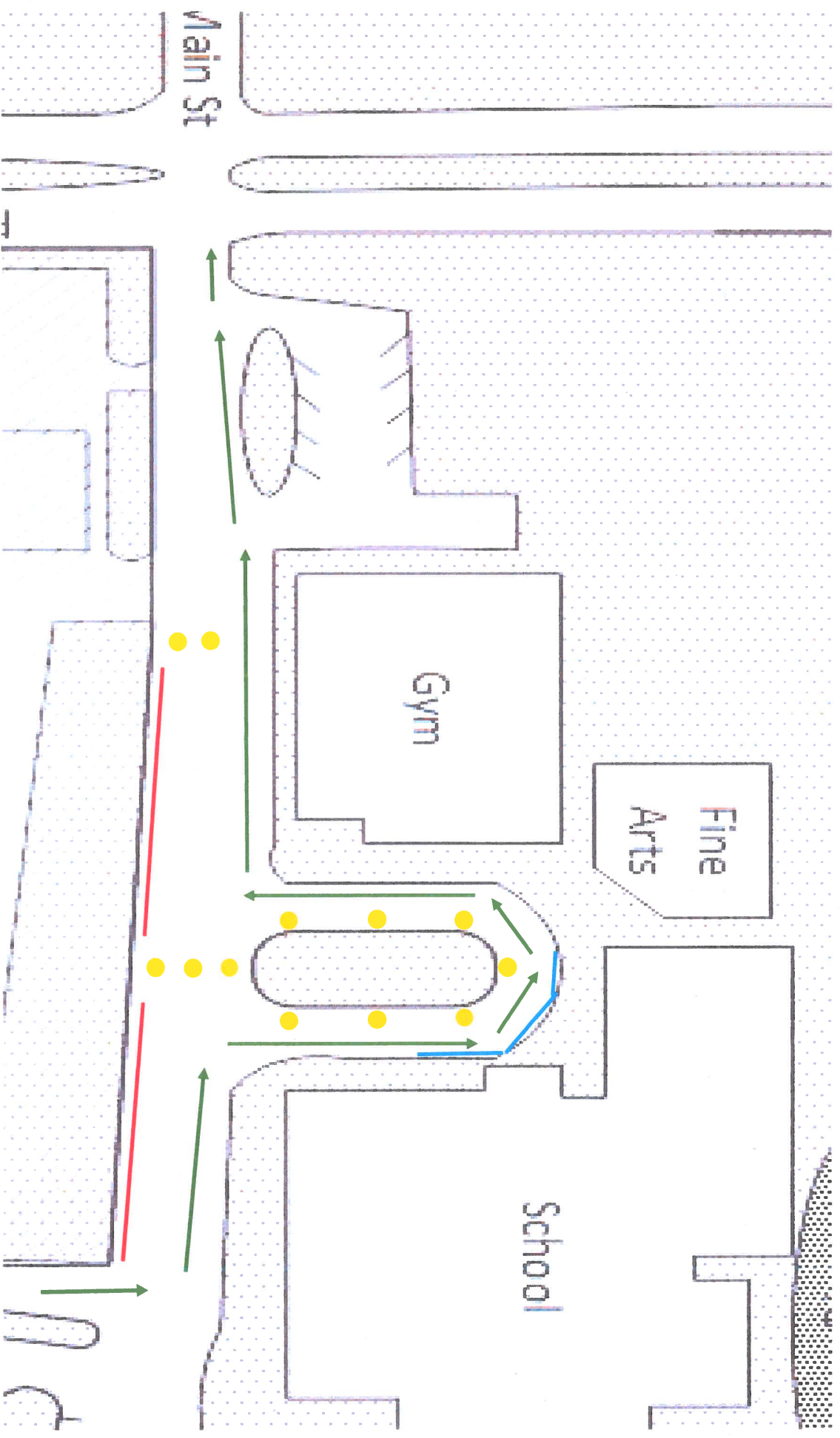

Follow the green errors on the diagram. Enter by way of the church parking lot and exit by way of Hospital Commons Blvd. Cones will be placed to block vehicle access from the wrong entrance, bypassing the loop and pulling out behind another car while in the loop. Please be patient and stay in line. Have your child(ren) ready to exit the vehicle by turning off electronic devices, putting away food or toys and having his or her backpack in hand when you enter campus. Do not let your child(ren) exit the vehicle until you have reached one of the drop off volunteers designated by the blue lines above. Do not park in the loop or to the side by Bloom designated by the red lines above. **NO CELL PHONES!!!** If your child(ren) needs assistance to carry in items or if you desire to walk your child(ren) into the building then please park in the church parking lot or the Multipurpose Facility's Parking Lot. Please be patient and remember you may drop off your child beginning at 7:15am.