

Our PARISH - Our FUTURE

A CAPITAL CAMPAIGN FOR CAMPUS IMPROVEMENTS

St. Mary of Mount Carmel Catholic Church

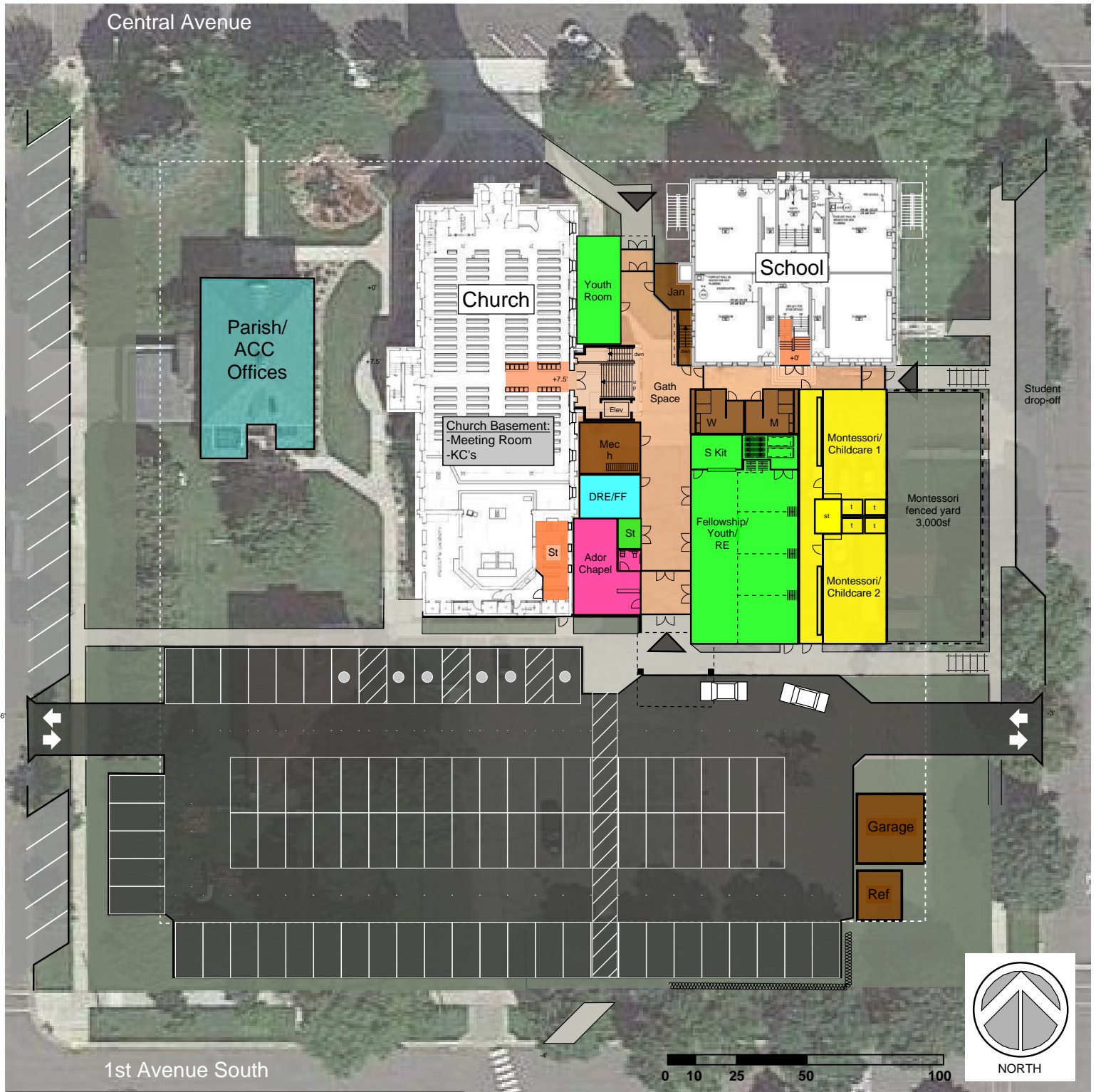

PROPOSED SITE/FLOOR PLAN

Space Program:

Gathering Space:	1,350 sf
Fellowship Hall:	2,350 sf
Fellowship: 190 seating capacity	
Religious Education: 4 classrooms	
School: Indoor recreation	
Serving Kitchen:	265 sf
Fellowship Hall Storage:	210 sf
Youth Room:	545 sf
Public Restroom:	635 sf
Adoration Chapel:	450 sf
Religious Education/Faith Formation:	305 sf
Montessori Classrooms:	2,300 sf
Mechanical/Electrical:	445 sf
Miscellaneous (corridor, walls, etc.):	2,585 sf
Church Entrance/Elevator:	<u>550 sf</u>

Total Building Area: 11,990 sf

Parking Lot:

Total Parking stalls:	84 stalls
Handicap parking stalls:	6 stalls
4 th Street angled parking:	17 stalls

Cost Summary

Building Addition:	\$4,855,000
Contingency:	\$400,000
Professional fees (incl. survey, etc.):	\$390,000
Other costs:	<u>\$55,000</u>
Total Estimated Project Cost:	\$5,700,000

Fundraising:

Fundraising to date:	\$3,165,000
Fundraising projected for the next 12-18 months:	<u>\$2,115,000</u>
Total fundraising:	\$5,280,000
Balance of funds needed:	\$420,000

Project Schedule

Schematic Design complete	October 2025
Design Development complete	November 2025
Construction Documents complete	February 2026
Bidding and Negotiating complete	March 2026
Start of Construction	June 2026
Demolition of Family Center	June 2027
Completion of Project	September 2027



Proposed North Entrance



Proposed Main Entry View



Church East Entrance



Proposed Aerial View